



TK International
020 7794 8700
www.t-k.co.uk

Residential Sales
Residential Lettings
Property Management

Sales Office:
9 Heath Street
Hampstead
London NW3 6TP
E: sales@t-k.co.uk

Lettings Office:
16-18 Heath Street
Hampstead
London NW3 6TE
E: lettings@t-k.co.uk

tk.international
TK International
TK International

Est.
1998



West Heath Avenue Golders Hill Park NW11

Located close by the beautiful open spaces of Golders Hill Park and its all weather and grass tennis courts, is this rarely available low built five/six bedroom contemporary two storey house which offers 3,162 sq ft of bright, lateral accommodation, all presented in very good decorative condition throughout.

The ground floor offers a double height entrance lobby flooded with light from the huge overhead skylight. Off of this is a 36' double reception room with a triple aspect over the west facing wrap-around garden. There is also a family/breakfast room leading directly into the kitchen, a large utility room, with plant room plus a study which doubles as a guest/maids suite with ensuite suite shower room.

The first floor provides a master suite with a double aspect, floor to ceiling windows, en-suite bathroom and large walk in closet, four further bedrooms and two further bathrooms, one en-suite.

The house sits on a corner position behind a driveway for three/four cars (as well as a large integral single garage) with secure sliding gates.

The comprehensive transport hub of Golders Green Underground Station (Northern Line) is located at the far end of West Heath Avenue as well as the excellent array of local supermarkets, specialist food shops, restaurants and cafes.

£3,250,000

SOLE AGENT

Freehold













West Heath Avenue NW11

Gross internal area (approx.)

294 Sq m (3163 Sq ft)

For identification only, Not to Scale



www.virtuallours.london

Not to scale, for guidance only and must not be relied upon as a statement of fact. All measurements and areas are approximate only (and have been prepared in accordance with the current edition of the RICS Code of Measuring Practice).

West Heath Avenue NW11

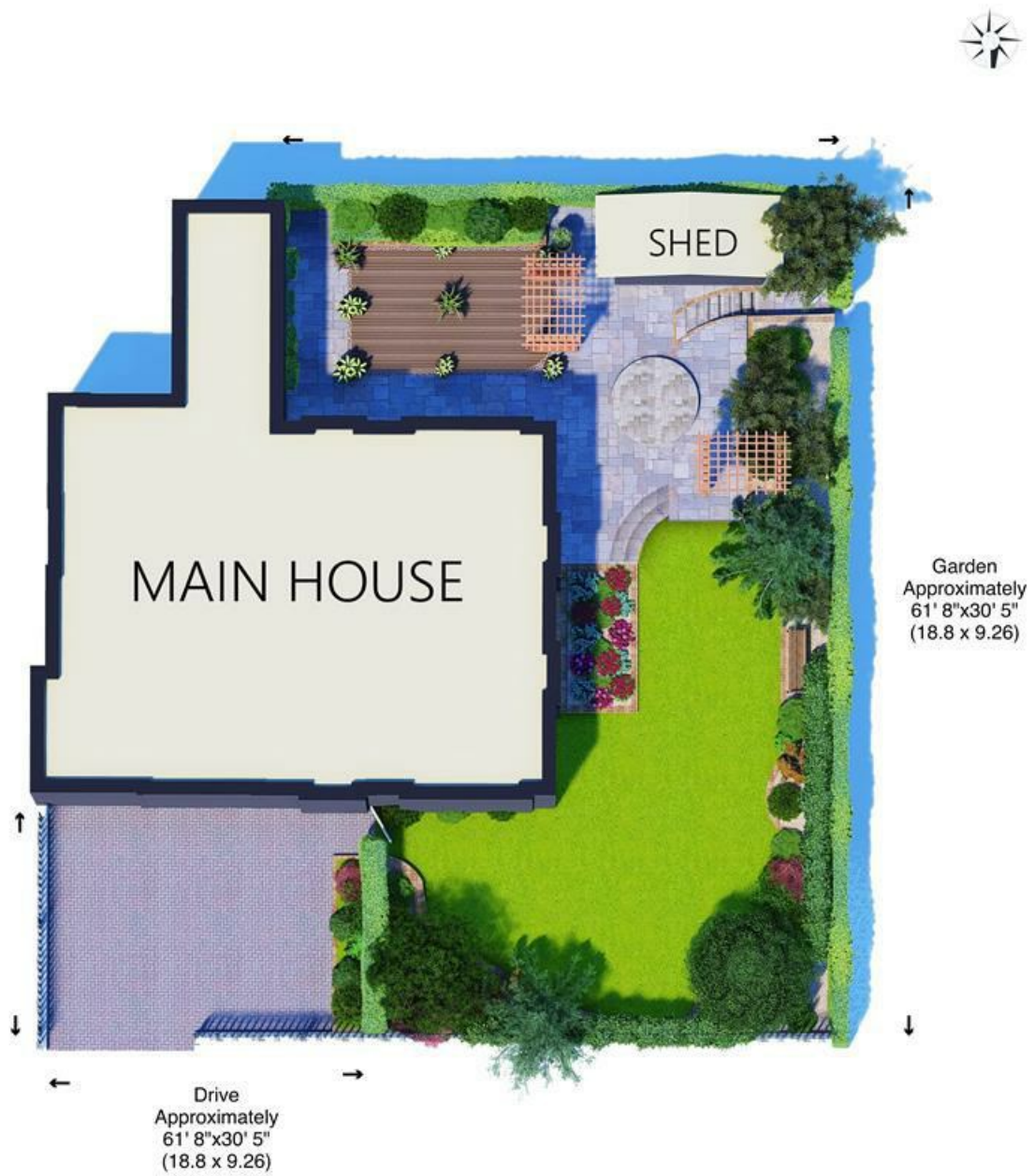

www.virtualtours.london

Not to scale, for guidance only and must not be relied upon as a statement of fact. All measurements and areas are approximate only (and have been prepared in accordance with the current edition of the RICS Code of Measuring Practice).